

Material

- Glazed titanium steel

Features

- with overflow hole
- with faucet hole bench
- installation kit and overflow set (ABS) included



Colors

- ☐ C058 White matte
- ☐ C__ Color class C, D, E



➔ color list

Options

- ☐ FH2 3-hole faucet (4")
- ☐ FH3 3-hole faucet (8")
- ☐ CE1 CLEANEFFECT
- ☐ OH0 Without overflow hole
- ☐ FH1 Single hole faucet
- ☐ FH0 without faucet hole

Accessories

- | | |
|---------------------------------|---|
| <input type="checkbox"/> 109547 | Schmidlin ELEMENT, magnetic candle holder |
| <input type="checkbox"/> 108242 | Schmidlin ELEMENT, magnetic glass holder |
| <input type="checkbox"/> 108243 | Schmidlin ELEMENT, magnetic soap dish |
| <input type="checkbox"/> 108241 | Schmidlin ELEMENT, magnetic soap dispenser |
| <input type="checkbox"/> 111479 | Schmidlin MAGNO magnetic soapdispenser white |
| <input type="checkbox"/> 111480 | Schmidlin MAGNO magnetic soapdispenser, black matte |
| <input type="checkbox"/> 111482 | Schmidlin MAGNO magnetic toothbrush holder, black matte |
| <input type="checkbox"/> 111481 | Schmidlin MAGNO magnetic toothbrush holder, white |
| <input type="checkbox"/> 100534 | Reinforcement flange for tap mounting |

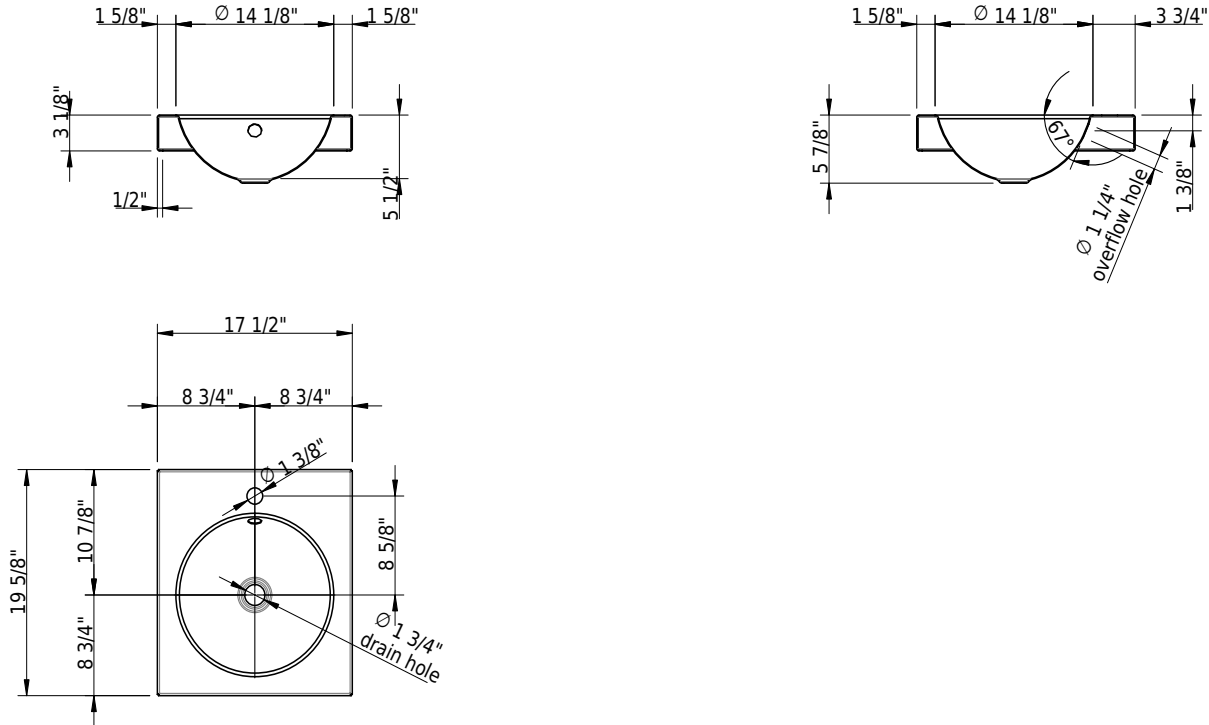

Technical Information

with faucet hole diameter	1 3/8"
Bowl configuration	single
Bowl depth	5 1/2"
Bowl size	Ø 14 1/8"
Water depth to overflow	3 5/8"
Drain hole diameter	1 3/4"



➤ Installation Instructions

Standards / Codes

- This product complies with
- ASME A112.19.1 / CSA B45.2
- ASTM F462

Notes

- Overflow-set included
- Drain and faucet not included
- Refer to installation instructions
- We recommend the use of Schmidlin reinforcement flange for faucet installation

Important: Dimensions of fixtures are nominal and may vary within the range tolerances established by ANSI standard A112.19.4. These measurements are subject to change or cancellation. No responsibility is assumed for use of superseded or voided leaflet.