

Material

- Glazed titanium steel

Features

- ANTIGLISS included
- Integrated tile flanges

Compatible drain fittings

- Mountain Plumbing offset, brass BDR20SBR22/FFF (cable drive)
- Mountain Plumbing offset, brass BDWUNV22/FFF (toe touch)
- Mountain Plumbing offset, ABS BWO40S22A2/FFF (cable drive)
- Mountain Plumbing offset, ABS BDWUNVA/FFF (toe touch)
- Mountain Plumbing offset, PVC BWO40S22P2/FFF (cable drive)
- Mountain Plumbing offset, PVC BDWUNVP/FFF (toe touch)
- OS&B offset, brass 314Q12-20FFF (clicker)
- OS&B offset, ABS 6040QK-FFF (clicker)
- OS&B offset, PVC 5150QK-FFF (clicker)
- Gerber direct, brass G004185135 Lift & Turn, 17 Gauge
- Gerber offset, brass G004181235 Trip Lever, 17 Gauge
- Gerber offset, brass G004181835 Trip Lever, 20 Gauge
- Gerber offset, brass G004185535 Lift & Turn , 20 Gauge
- Gerber offset ABS G0041613 Trip Lever
- Gerber offset PVC G0041553 Lift & Turn
- Geberit offset, PP 150.183.00.1 (rough-in unit)
- Geberit offset, brass 151.450.00.1 (rough-in unit)



| Variant no | Color | Tile flange | |
|------------------------------------|----------------|---|--|
| <input type="checkbox"/> 2300-0003 | C1 white gloss | TF01 Tile flanges left / back, drain left | |
| <input type="checkbox"/> 2300-0004 | C1 white gloss | TF02 Tile flanges right / back, drain right | |

Colors

- ☐ C058 White matte
- ☐ C__ Color class C, D



➤ color list

Options

- ☐ CE1 CLEANEFFECT
- ☐ HC2 Handle CONTURA
- ☐ HS2 Handle SAFE

Accessories

- ☐ 108240 Schmidlin ELEMENT magnetic towel holder, chrome-plated
- ☐ 109547 Schmidlin ELEMENT, magnetic candle holder
- ☐ 101187 Schmidlin RELAX bathtub pillow, black, 1 piece
- ☐ 117005 Schmidlin 2-corner tape-flange, 155" (4m)

09/18/2025 Subject to technical changes.

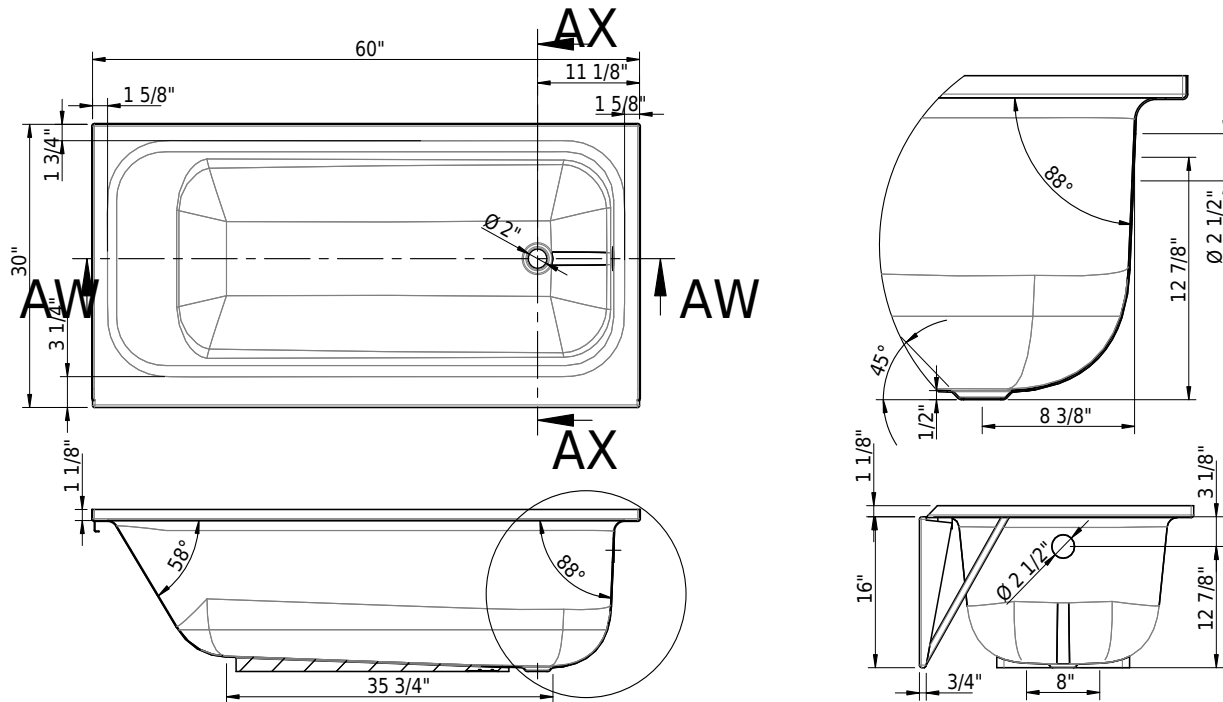

Technical Information

| | |
|---------------------------------|---------|
| Installation location | alcove |
| Weight without water | 115 lbs |
| Water depth to overflow | 11 1/2" |
| Max. water capacity to overflow | 42 gal |
| Drain opening | 2" |
| Overflow hole diameter | 2 1/2" |



➤ Installation Instructions



➤ Installation Video

Standards / Codes

- This product complies with
- ASME A112.19.1 / CSA B45.2
- ASTM F462
- ADA



Meets the americans with disabilities act guidelines and ANSI A117.1 requirements for accessibility and usability - check local code. Install with seat at head end.

Notes

- Right hand outlet shown
- Bath faucet not included
- Refer to installation instructions

Important: Dimensions of fixtures are nominal and may vary within the range tolerances established by ANSI standard A112.19.4. These measurements are subject to change or cancellation. No responsibility is assumed for use of superseded or voided leaflet.

09/18/2025 Subject to technical changes.